

## HP-50Z

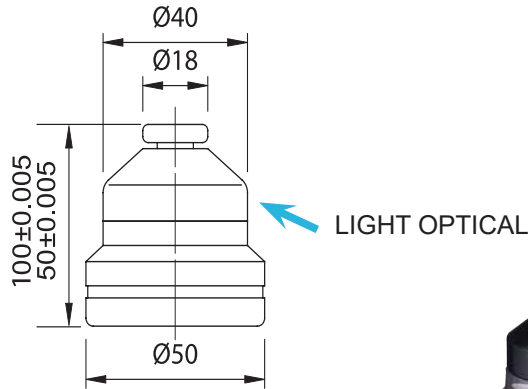

HP-50Z BATTERY  
LR4476AG13  
1SET/2PCS  
HP-50ZM  
LR44  
1SET/2PCS

MODEL For NEXT

- Height 50 mm and 100 mm.
- With Magnetic base.
- The red lamp will be lighted up when touched.
- Accuracy 0.005 mm.
- Combined vertical and horizontal in a unit.
- Weight:0.7 kgs



HP-100ZM

HP-100Z

HEIGHT PRESETTER

- A. HP-50 / 100 / ZM / EM SERIES BUILT-IN MEGNETS FOR EASIER SETUP. VERTICAL & HORIZONTAL !
- B. STANDARD HEIGHT : 50 OR 100 MM
- C. WEIGHT ABOUT 0.7-1.2 KGS
- D. WHEN TOUCHED, THE RED LAMP LIGHTS ON.
- E. ACCURACY : WITHIN 0.005 MM
- F. BATTERY TYPE : LR44 / A76 / G13 X 2 PCS

MANUAL:

1. THERE IS A MECHNISM BELOW THE TOUCH PLATE CAN BE ADJUSTED BY GAUGE BLOCK.
  2. WHEN MACHINE SPEED IS HIGH, PLEASE REDUCE THE SPEED & GO UP /DOWNWARD UNTIL THE RED LIGHT IS OFF.
  3. PROCEED AGAIN IN LOWER SPEED.
  4. HORIZONTAL POSITION (HPXXX-XXEM/ZM SERIES-MAGNETIC FUNC.ONLY)  
PLEASE USE THE TOP TIP OF THE CUTTER TO TOUCH THE TOUCH PLATE.
- ※ CAN NOT USE VERNIER TO CHECK / RE-SET

### EXAMPLE

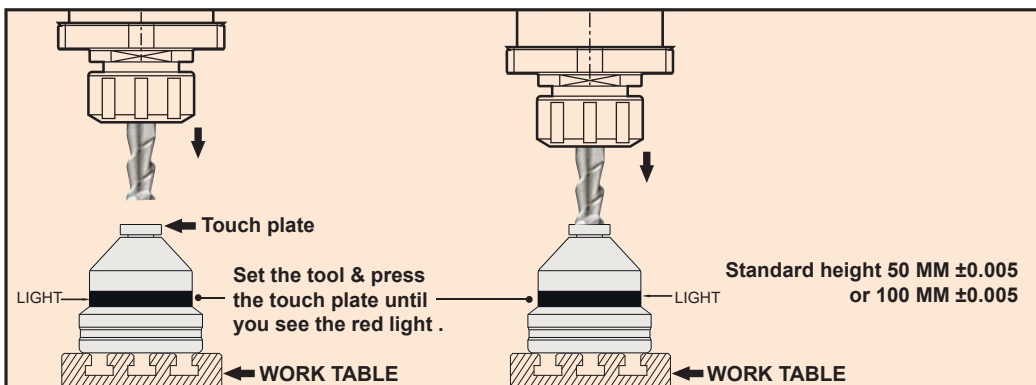

ORDER NO.	H	STYLE	WEIGHT (kg)		CODE NO.
			N.W.	G.W.	
HP-50Z	50mm	STANDARD TYPE	0.32	0.7	3403-001
HP-50ZM	50mm	WITH MAGNETIC BASE	0.32	0.7	3403-002
HP-100Z	100mm	STANDARD TYPE	1.0	1.25	3403-003
HP-100ZM	100mm	WITH MAGNETIC BASE	1.0	1.22	3403-004

**NEW**



# Electronic Tool Length Setter



STAINLESS STEEL BASE WITH MAGNET

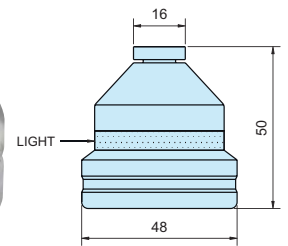
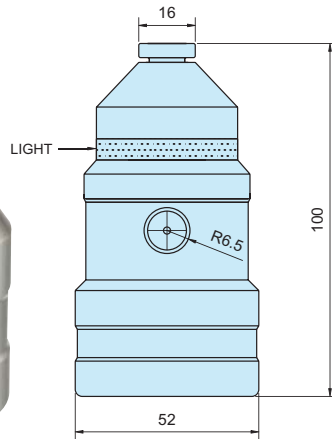

## EXAMPLE

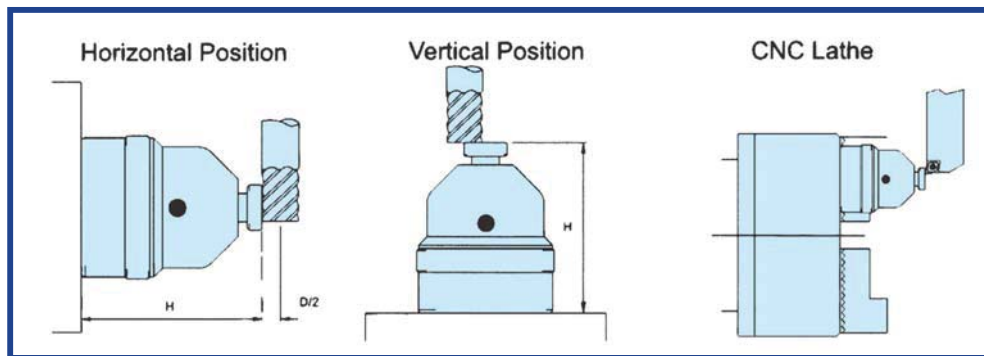

### ● HIGH ACCURACY

### ● EASY OPERATION

- Be sure to remove all chips and all from the sensor plate and the base of the HP-50E as well as from the workpiece and tool.
- To move the tool approaching the sensor plate slowly.
- When touching, the "LED" turns on immediately and "H" is just 50.00 mm.(or2")
- LED will not function if batteries are not set in correctly.
- Designed to be used on ferrous.

ORDER NO.	H	STYLE	WEIGHT(kg) N.W.	CODE NO.
HP-50EM	50mm	WITH MAGNETIC BASE	0.32	3403-032
HP-100EM	100mm		1.0	3403-033

### Stainless Steel Base With Magnet

TOOL PRE-SETTER FOR MACHINING CENTERS.  
CNC & STANDARD MILLING MACHINES AND  
CNC & STANDARD LATHES



HP-50A



HP-100AM

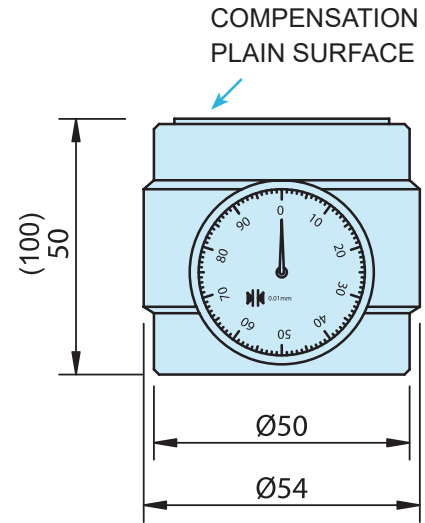

CHECKING BAR FOR 50 OR 100 MM POSITION AT ZERO POINT

Z-ZERO-SETTER



HP-50B

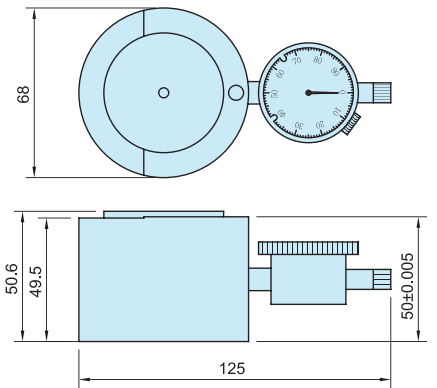
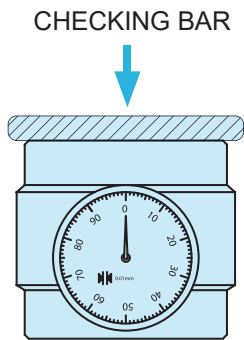

CHECKING BAR FOR 50 OR 100 MM POSITION AT ZERO POINT

- Have the central measuring part of the zero setter presetter against a plain surface and aligned if with the outer reference surface. Turn the dial gauge for zero setting.
- Have the cutter touched against the z zero setter.
- Once the indicator position at zero, the distance between the tool tip to workpiece is 50mm,  $\pm 0.005$ , 100 mm,  $\pm 0.005$ .

### EXAMPLE

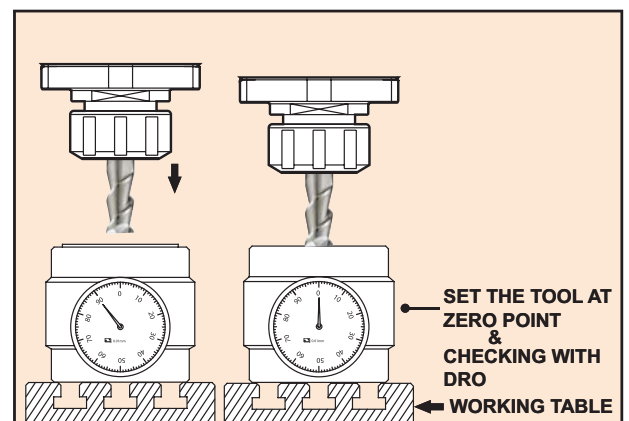

ORDER NO.	H	STYLE	WEIGHT (kg)	CODE NO.
HP-50A	50mm	STANDARD TYPE	1.1	3403-020
HP-50B			1.7	3403-021
HP-50AM		WITH MAGNETIC BASE	1.2	3403-022
HP-50BM			1.7	3403-023
HP-100A	100mm	STANDARD TYPE	1.78	3403-024
HP-100AM		WITH MAGNETIC BASE	1.77	3403-025

**NEW**