

Light Duty Live Center

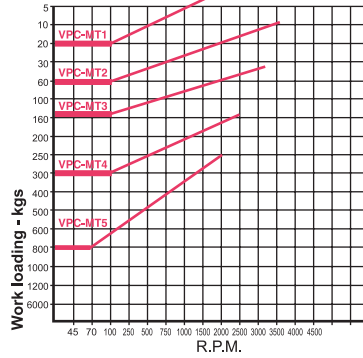
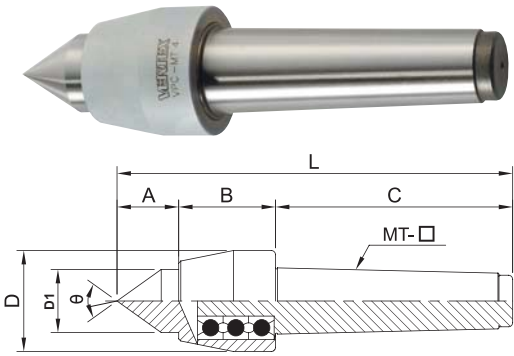

- Center is made of SCM420 alloy steel by heat treatment to provide higher rigidity (HRC60°±2°) and satisfied wear-resistance.
- Center is constituted by ball bearings assembly.
- Applicable to middle-speed & high-speed lathe with light load.

※Suggested tailstock pressure under 6 kg/cm²

FOR VPC-TYPE

Unit:mm

| ORDER NO. | A | B | C | D | D1 | L | Accuracy | Speed Max R.P.M. | θ | G.W. weight kgs | PACKING LxWxH | CODE NO. |
|-----------|----|----|-----|----|----|-----|----------|------------------|-----|-----------------|----------------|----------|
| VPC-MT1 | 21 | 31 | 56 | 32 | 16 | 108 | 0.005 | 3200 | 60° | 0.3 | 115 x 136 x 38 | 5001-001 |
| VPC-MT2 | 26 | 37 | 69 | 40 | 22 | 132 | 0.005 | 2800 | 60° | 0.5 | 140 x 45 x 45 | 5001-002 |
| VPC-MT3 | 32 | 46 | 86 | 45 | 26 | 164 | 0.005 | 2000 | 60° | 0.9 | 170 x 50 x 52 | 5001-003 |
| VPC-MT4 | 34 | 46 | 108 | 48 | 30 | 188 | 0.005 | 1800 | 60° | 1.3 | 195 x 58 x 56 | 5001-004 |
| VPC-MT5 | 50 | 62 | 136 | 68 | 45 | 248 | 0.005 | 1500 | 60° | 3.2 | 268 x 86 x 77 | 5001-005 |

Live Lathe Center



A TYPE

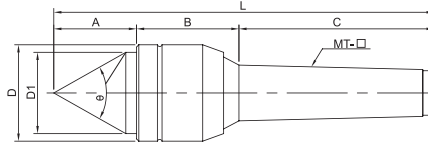

B TYPE

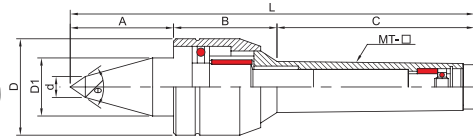

- Center shaft & main body is made of SCM420 alloy steel by heat treatment to provide higher rigidity (HRC60°±2°) and satisfied wear-resistance.
- Center is constituted by thrust ball bearing, needle roller bearings & ball bearings assembly.
- Applicable to middle-speed & high-speed lathe with heavy load.

※ B TYPE SUITABLE FOR SMALL -WORKPIECE MACHINING.

※Suggested tailstock pressure under 6 kg/cm²

Unit:mm

| ORDER NO. | TYPE | A | B | C | D | D1 | d | L | Accuracy | Speed Max R.P.M. | θ | G.W. weight kgs | PACKING LxWxH | CODE NO. |
|-----------|------|----|----|-----|----|----|----|-----|----------|------------------|-----|-----------------|---------------|----------|
| VLC-212 | MT2A | 28 | 35 | 69 | 32 | 23 | - | 132 | 0.005 | 4000 | 60° | 0.3 | 173 x 43 x 40 | 5001-010 |
| VLC-213 | MT3A | 36 | 44 | 86 | 41 | 35 | - | 166 | 0.005 | 3000 | 60° | 0.9 | 198 x 67 x 51 | 5001-011 |
| VLC-214 | MT4A | 41 | 51 | 108 | 47 | 40 | - | 200 | 0.005 | 2500 | 60° | 1.5 | 240 x 70 x 61 | 5001-012 |
| VLC-215 | MT5A | 54 | 72 | 136 | 65 | 52 | - | 262 | 0.005 | 2000 | 60° | 3.8 | 290 x 92 x 80 | 5001-013 |
| VLC-213B | MT3B | 46 | 44 | 86 | 41 | 25 | 10 | 176 | 0.005 | 3000 | 60° | 0.9 | 198 x 67 x 51 | 5001-014 |
| VLC-214B | MT4B | 55 | 51 | 108 | 47 | 32 | 12 | 214 | 0.005 | 2500 | 60° | 1.5 | 240 x 70 x 61 | 5001-015 |

THE CHART FOR LOADING WEIGHT WITH R.P.M.

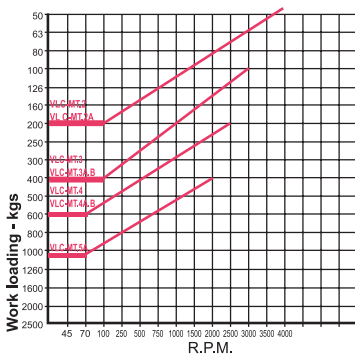

FOR VLC-TYPE

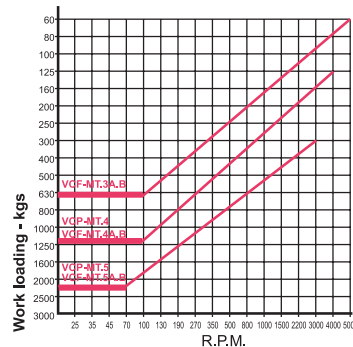

FOR VCF/VCP-TYPE

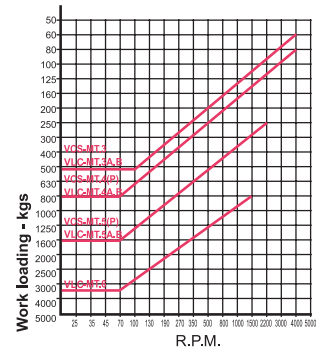

FOR VCS-TYPE



A TYPE

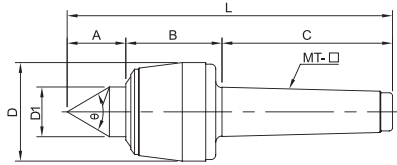

B TYPE

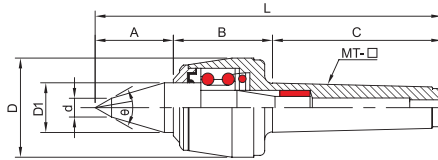

WATER-PROOF TYPE

- Center shaft is made of SUJ2 material under vacuum heat treatment to provide higher rigidity (HRC60°±2°) and satisfied wear-resistance.
 - Center is constituted by dual ball bearing. Thrust bearing & needle roller bearing assembly.
 - Applicable to high-speed lathe & NC lathe with heavy load
 - water-proof.
- ※ B Type is applicable in the metal workings on small diameter workpieces.

※Suggested tailstock pressure under 6 kg/cm²

Unit:mm

| ORDER NO. | TYPE | A | B | C | D | D1 | d | L | Accuracy | Speed Max R.P.M. | θ | G.W. weight kgs | PACKING LxWxH | CODE NO. |
|-----------|------|----|-----|-----|-----|----|----|-----|----------|------------------|-----|-----------------|-----------------|----------|
| VLC-MT3A | MT3A | 39 | 51 | 86 | 53 | 30 | - | 176 | 0.005 | 4000 | 60° | 1.3 | 240 x 70 x 61 | 5001-020 |
| VLC-MT4A | MT4A | 42 | 62 | 108 | 63 | 32 | - | 212 | 0.005 | 3000 | 60° | 2.2 | 253 x 92 x 80 | 5001-021 |
| VLC-MT5A | MT5A | 57 | 71 | 136 | 83 | 40 | - | 264 | 0.005 | 2500 | 60° | 4.5 | 303 x 108 x 101 | 5001-022 |
| VLC-MT6A | MT6A | 80 | 111 | 189 | 128 | 70 | - | 380 | 0.008 | 1500 | 60° | 15.6 | 410 x 177 x 168 | 5001-023 |
| VLC-MT3B | MT3B | 48 | 52 | 86 | 53 | 30 | 10 | 186 | 0.005 | 4000 | 60° | 1.4 | 240 x 70 x 61 | 5001-024 |
| VLC-MT4B | MT4B | 52 | 62 | 108 | 63 | 32 | 12 | 218 | 0.005 | 3000 | 60° | 2.2 | 253 x 92 x 80 | 5001-025 |
| VLC-MT5B | MT5B | 67 | 71 | 136 | 83 | 40 | 14 | 274 | 0.005 | 2500 | 60° | 4.5 | 303 x 108 x 101 | 5001-026 |



High-Load NC Live Center



A TYPE

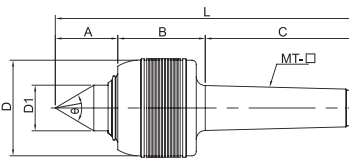

B TYPE

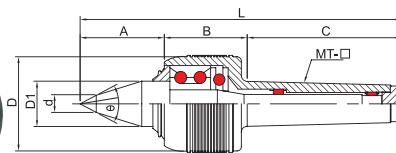

- Shaft uses material SUJ2: through vacuum heat treatment, it is even more durable, hardness is as high as (HRC60°±2°) and satisfied wear-resistance.
 - Front end is constituted by angular contact ball bearing & thrust ball bearing. middle & rear ends are comprised of needle roller bearing assembly.
 - These centers are suitable for NC lathe at high-speed & heavy-load operation, water-proof.
- ※ B Type is applicable in the metal workings on small workpieces.

※Suggested tailstock pressure under 6 kg/cm²

Unit:mm

| ORDER NO. | A | B | C | D | D1 | d | L | Accuracy | Speed Max R.P.M. | θ | G.W. weight kgs | PACKING LxWxH | CODE NO. |
|-----------|----|----|-----|----|----|----|-----|----------|------------------|-----|-----------------|-----------------|----------|
| VCF-MT3A | 38 | 50 | 86 | 53 | 30 | - | 174 | 0.003 | 5000 | 60° | 1.3 | 240 x 70 x 61 | 5001-030 |
| VCF-MT4A | 45 | 60 | 108 | 68 | 32 | - | 213 | 0.003 | 4500 | 60° | 2.4 | 253 x 92 x 80 | 5001-031 |
| VCF-MT5A | 52 | 70 | 136 | 87 | 40 | - | 258 | 0.003 | 3000 | 60° | 5 | 303 x 108 x 101 | 5001-032 |
| VCF-MT3B | 52 | 50 | 86 | 53 | 25 | 10 | 188 | 0.003 | 5000 | 60° | 1.3 | 240 x 70 x 61 | 5001-033 |
| VCF-MT4B | 55 | 60 | 108 | 68 | 32 | 12 | 223 | 0.003 | 4500 | 60° | 2.4 | 253 x 92 x 80 | 5001-034 |
| VCF-MT5B | 67 | 70 | 136 | 87 | 40 | 14 | 273 | 0.003 | 3000 | 60° | 5 | 303 x 108 x 101 | 5001-035 |



Inter-changeable Points Live Center

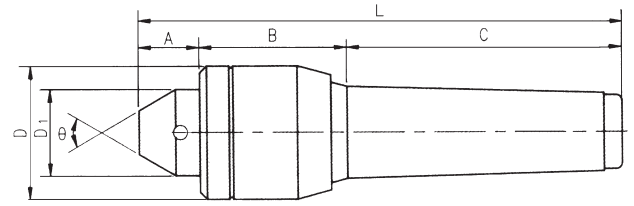

- Complete set with 7 Interchangeable Points for various processing.
- Packed in case.
- High accuracy and durability as well as complete rust-proof performance
- Center made of SCM420 special tool steel hardened and ground can be used for heavy duty work.

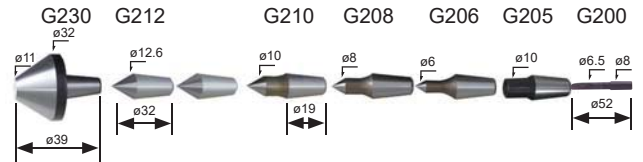

※Suggested tailstock pressure under 6 kg/cm²

Unit:mm

| ORDER NO. | TYPE | A | B | C | D | D1 | L | Accuracy | Speed Max. R.P.M. | θ | G.W. weight kgs | PACKING LxWxH | CODE NO. |
|-----------|------|----|----|-----|----|----|-----|----------|-------------------|-----|-----------------|-----------------|----------|
| VLC-312 | MT2 | 22 | 36 | 69 | 32 | 25 | 127 | 0.008 | 4000 | 60° | 0.9 | 166 x 105 x 63 | 5001-040 |
| VLC-313 | MT3 | 23 | 44 | 86 | 41 | 30 | 153 | 0.008 | 3000 | 60° | 1.4 | 255 x 138 x 100 | 5001-041 |
| VLC-314 | MT4 | 23 | 51 | 108 | 47 | 32 | 182 | 0.008 | 2500 | 60° | 2 | 255 x 138 x 100 | 5001-042 |



High Speed NC Interchangeable Points Live Center

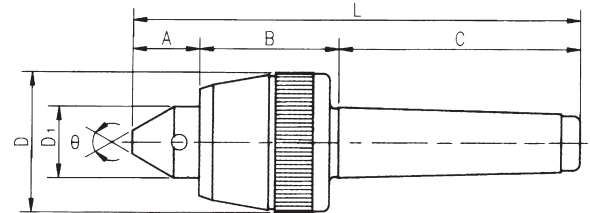

VCS-MT3, MT4

VCS-MT4P, MT5P

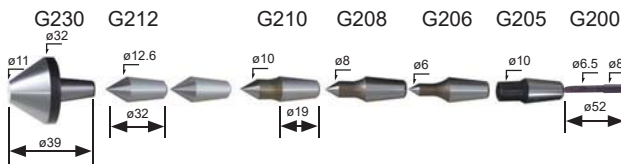

- Center shaft is made of SUJ2 material under vacuum heat treatment to provide higher rigidity (HRC60°±2°) and satisfied wear-resistance.
- Center is constituted by dual ball bearing. Thrust bearing & needle roller bearing assembly.
- Suit for to high-speed lathe & NC lathe with heavy load, water-proof.

※Suggested tailstock pressure under 6 kg/cm²

Unit:mm

| ORDER NO. | A | B | C | D | D1 | L | Accuracy | Speed Max. R.P.M. | θ | G.W. weight kgs | PACKING LxWxH | CODE NO. |
|-----------|----|----|-----|----|----|-----|----------|-------------------|-----|-----------------|-----------------|----------|
| VCS-MT3 | 28 | 51 | 86 | 53 | 30 | 165 | 0.008 | 4000 | 60° | 1.8 | 255 x 138 x 100 | 5001-050 |
| VCS-MT4 | 30 | 62 | 108 | 63 | 32 | 196 | 0.008 | 3500 | 60° | 2.5 | 255 x 138 x 100 | 5001-051 |
| VCS-MT4P | 30 | 62 | 108 | 63 | 32 | 196 | 0.008 | 3500 | 60° | 2.7 | 235 x 130 x 80 | 5001-052 |
| VCS-MT5P | 34 | 71 | 136 | 83 | 40 | 237 | 0.008 | 2500 | 60° | 5.1 | 275 x 147 x 97 | 5001-053 |

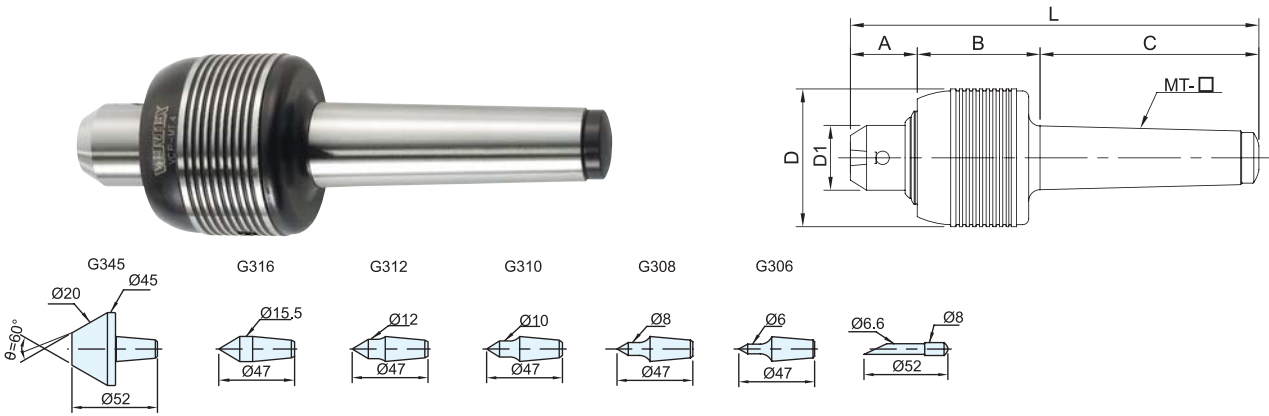

- Shaft uses material SUJ2:through vacuum heat treatment, it is even more durable, hardness is as high as (HRC60^{±2}) and satisfied wear-resistance.
- Front end is constituted by SKF angular contact ball bearing & thrust ball bearing. middle & rear ends are comprised of needle roller bearing assembly.
- These centers are suitable for NC lathe at high-speed & heavy-load operation, water-proof.

※Suggested tailstock pressure under 6 kg/cm²

Unit:mm

| ORDER NO. | A | B | C | D | D1 | L | Accuracy | Speed Max. R.P.M. | θ | G.W. weight kgs | PACKING LxWxH | CODE NO. |
|-----------|----|----|-----|----|----|-----|----------|-------------------|-----|-----------------|----------------|----------|
| VCP-MT4 | 30 | 64 | 108 | 68 | 32 | 202 | 0.005 | 4500 | 60° | 3 | 253 x 130 x 80 | 5001-060 |
| VCP-MT5 | 37 | 70 | 136 | 87 | 40 | 243 | 0.005 | 3000 | 60° | 5.5 | 275 x 147 x 97 | 5001-061 |



High Speed Live Center



EURO STYLE

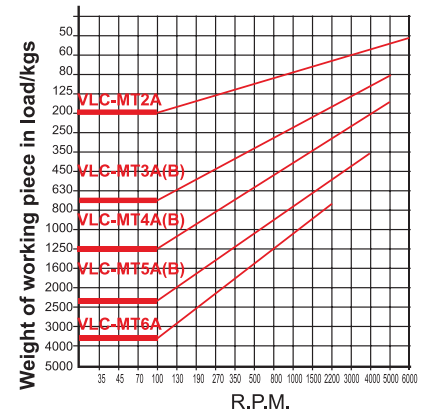
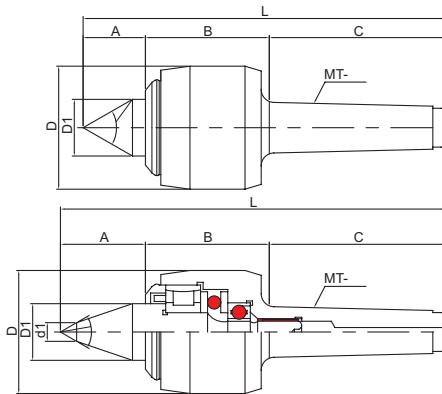
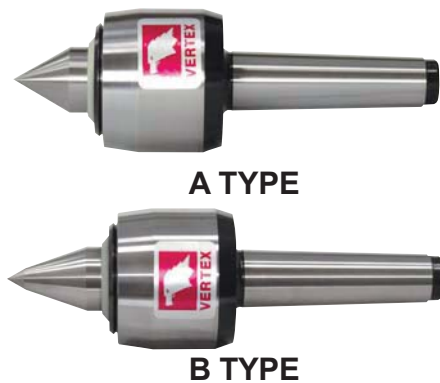

- Suit for to CNC lathes, can be used at high speed turning and with waterproof design.
 - The shaft is made of alloy steel and through vacuum heat treatment HRC 60^{±2}. It has high rigidity and high durability.
 - The center uses the combination of roller bearing, thrust ball bearing and ball bearing.
- ※ B Type is applicable in the metal workings on small workpieces.

※Suggested tailstock pressure under 6 kg/cm²

Unit:mm

| ORDER NO. | TYPE | A | B | C | D | D1 | L | d1 | Accuracy | Speed Max. R.P.M | θ | G.W. weight | PACKING L x W x H | CODE NO. |
|-----------|------|----|----|-----|----|----|-----|----|----------|------------------|-----|-------------|-------------------|----------|
| VLC-512 | MT2A | 20 | 46 | 69 | 32 | 13 | 135 | - | 0.003 | 6000 | 60° | 0.8 | 240x70x61 | 5001-062 |
| VLC-513 | MT3A | 34 | 61 | 86 | 58 | 25 | 181 | - | 0.003 | 5200 | 60° | 1.8 | 253x92x80 | 5001-063 |
| VLC-514 | MT4A | 44 | 67 | 114 | 76 | 35 | 225 | - | 0.003 | 5000 | 60° | 3.2 | 290x92x80 | 5001-064 |
| VLC-515 | MT5A | 55 | 88 | 142 | 95 | 45 | 285 | - | 0.003 | 3500 | 60° | 5.6 | 303x108x101 | 5001-065 |
| VLC-513B | MT3B | 45 | 61 | 86 | 58 | 25 | 192 | 10 | 0.003 | 5200 | 60° | 1.8 | 290x92x80 | 5001-067 |
| VLC-514B | MT4B | 55 | 67 | 114 | 76 | 35 | 236 | 12 | 0.003 | 5000 | 60° | 3.2 | 253x92x80 | 5001-068 |
| VLC-515B | MT5B | 67 | 88 | 142 | 95 | 45 | 297 | 14 | 0.003 | 3500 | 60° | 6.0 | 303x108x101 | 5001-069 |



HARDEN PROCESS : HRC50°
 CONCENTRICITY : 0.005mm
 ROUNDNESS : 0.005mm
 MATERIAL : STEEL

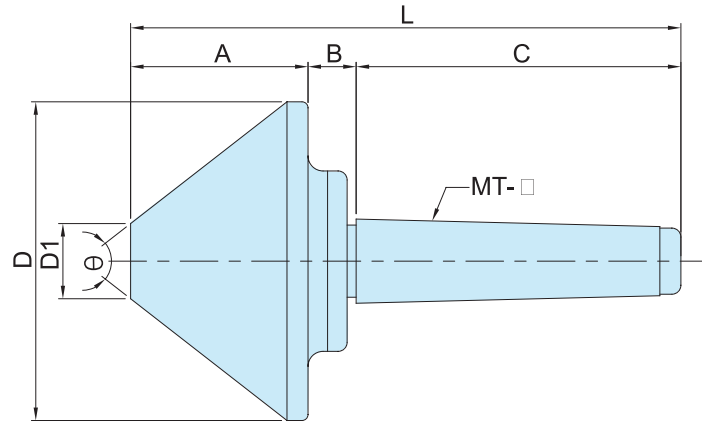

※Suggested tailstock pressure under 6 kg/cm²

Unit:mm

| ORDER NO. | SIZE MTxD | A | B | C | D | D1 | L | Speed Max. R.P.M. | θ | R.P.M.100 LOAD WEIGHT (KGS) | G.W. weight (KGS) | CODE NO. |
|-----------|------------|-----|----|-----|------|-----|-----|-------------------|-----|-----------------------------|-------------------|-----------|
| VLC-422 | MT2×2 1/2" | 48 | 12 | 69 | 63.5 | 12 | 128 | 3000 | 60° | 200 | 0.9 | 5001-070A |
| VLC-423 | MT2×3" | 56 | 12 | 69 | 78 | 19 | 138 | 2500 | 60° | 400 | 1.3 | 5001-070B |
| VLC-424 | MT2×4" | 58 | 12 | 69 | 106 | 32 | 141 | 2000 | 70° | 640 | 2.3 | 5001-070C |
| VLC-433 | MT3×3" | 52 | 18 | 86 | 78 | 19 | 156 | 3300 | 60° | 400 | 1.6 | 5001-070 |
| VLC-434 | MT3×4" | 59 | 16 | 86 | 106 | 32 | 161 | 3000 | 70° | 500 | 2.8 | 5001-071 |
| VLC-435 | MT3×5" | 71 | 12 | 89 | 128 | 35 | 173 | 1900 | 70° | 960 | 4.2 | 5001-071A |
| VLC-436 | MT3×6" | 81 | 12 | 89 | 156 | 50 | 183 | 1900 | 70° | 1200 | 7.3 | 5001-071B |
| VLC-443 | MT4×3" | 52 | 18 | 108 | 78 | 19 | 178 | 3300 | 60° | 400 | 1.8 | 5001-072 |
| VLC-444 | MT4×4" | 59 | 16 | 108 | 106 | 32 | 183 | 3000 | 70° | 500 | 3.1 | 5001-073 |
| VLC-445 | MT4×5" | 73 | 12 | 108 | 128 | 35 | 193 | 2000 | 70° | 650 | 4.9 | 5001-074 |
| VLC-446 | MT4×6" | 88 | 12 | 108 | 156 | 50 | 208 | 1900 | 70° | 800 | 7.7 | 5001-075 |
| VLC-448 | MT4×8" | 98 | 12 | 108 | 206 | 54 | 218 | 1500 | 75° | 1300 | 15.4 | 5001-076 |
| VLC-4410 | MT4×10" | 107 | 13 | 110 | 258 | 92 | 236 | 1000 | 80° | 2000 | 24 | 5001-076A |
| VLC-454 | MT5×4" | 58 | 12 | 143 | 106 | 32 | 214 | 2000 | 70° | 640 | 4 | 5001-077A |
| VLC-455 | MT5×5" | 73 | 12 | 136 | 128 | 35 | 221 | 2000 | 70° | 650 | 5.8 | 5001-077 |
| VLC-456 | MT5×6" | 88 | 12 | 136 | 156 | 50 | 236 | 1900 | 70° | 800 | 8.6 | 5001-078 |
| VLC-458 | MT5×8" | 98 | 12 | 136 | 206 | 54 | 246 | 1500 | 75° | 1600 | 15.7 | 5001-079 |
| VLC-4510 | MT5×10" | 107 | 13 | 143 | 258 | 92 | 264 | 1000 | 80° | 2200 | 25.5 | 5001-079A |
| VLC-4512 | MT5×12" | 110 | 25 | 143 | 306 | 120 | 281 | 1000 | 90° | 3000 | 37.5 | 5001-079B |
| VLC-466 | MT6×6" | 81 | 12 | 185 | 156 | 50 | 281 | 1900 | 70° | 1200 | 12 | 5001-080A |
| VLC-468 | MT6×8" | 103 | 13 | 185 | 206 | 54 | 298 | 1500 | 75° | 2000 | 15.8 | 5001-080 |
| VLC-4610 | MT6×10" | 107 | 13 | 185 | 258 | 92 | 306 | 1000 | 80° | 2500 | 28 | 5001-081 |
| VLC-4612 | MT6×12" | 110 | 25 | 185 | 306 | 120 | 323 | 1000 | 90° | 3000 | 40 | 5001-082 |