



# ER Spring Collet Chuck System



Collet Chuck Kit With ISO Taper Shank DIN 2080/ISO SHANK  
DIN 6499



NT-40

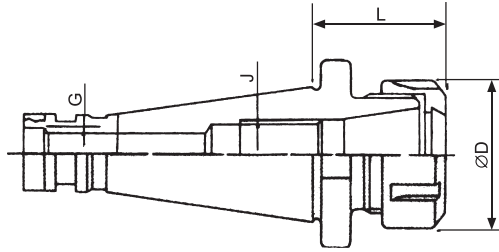

ER



ORDER NO.	TAPER	COLLET TYPE	L	D	G	WEIGHT KGS	CODE NO.
V-101	NT-30	ER-32	55	50	1/2"-12W, M12X1.75P (USA 1/2"-UNC13)	0.7	3020-301
V-102		ER-40	70	63		1.1	3020-302
V-103	NT-40	ER-32	50	60	5/8"-11W or M16X2.0P	1.1	3021-301
V-104		ER-40	60	63		1.3	3021-302
V-105		ER-50	80	78		2	3021-303
V-106	NT-50	ER-32	60	50	1"-8W or M24X3.0P	3.1	3022-301
V-107		ER-40	65	63		3.4	3022-302
V-108		ER-50	65	78		4	3022-303
※ V-109	NT-30	ER-25	55	42	1/2"-12W, M12X1.75P	0.7	3020-303
※ V-110	NT-40	ER-25	50	42	5/8"-11W, M16X2.0P	1.1	3021-304



## Collet Chuck kit With ISO Taper Shank

Including shank, full set of collets, wrench and case.



NT-30

### Caution:

Please notify the taper size, collte type, set range, and set numbers when ordering.



ORDER NO.	TAPER	COLLET TYPE	SET RANGE	SET PCS	WEIGHT KGS	CODE NO.
V-201	NT-30	ER-32	3-20	18	4.2	3020-401
V-202			4-20	11	3.2	3020-402
V-203			6-20	6	2.8	3020-403
V-204	NT-30	ER-40	4-26	23	7.3	3020-404
V-205			4-26	15	6	3020-405
V-206			6-25	7	4.6	3020-406
V-207	NT-40	ER-32	3-20	18	4.8	3021-401
V-208			4-20	11	3.8	3021-402
V-209			6-20	6	3.4	3021-403
V-210	NT-40	ER-40	4-26	23	8.2	3021-404
V-211			4-26	15	6.9	3021-405
V-212			6-25	7	5.2	3021-406
V-213	NT-40	ER-50	12-34	12	10	3021-407
V-214	NT-50	ER-32	3-20	18	6.4	3022-401
V-215			4-20	11	5.4	3022-402
V-216			6-20	6	5.5	3022-403
V-217	NT-50	ER-40	4-26	23	9.8	3022-404
V-218			4-26	15	8.5	3022-405
V-219			6-25	7	7	3022-406
V-220	NT-50	ER-50	12-34	12	11	3022-407
※ V-223	NT-30	ER-25	2-16	7	2.8	3020-407
※ V-224			4-16	15	2.4	3020-408
※ V-225	NT-40	ER-25	2-16	7	3.3	3021-409
※ V-226			4-16	15	3.0	3021-410