



Magnetic V Block



1 PCS

- For round / square workpiece
- For checking on surface plate during the production.
- For measuring
- V ANGLE 90°
- ※ Not for LAB.

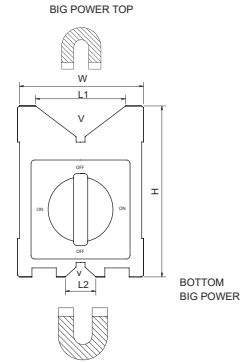
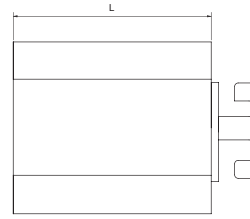
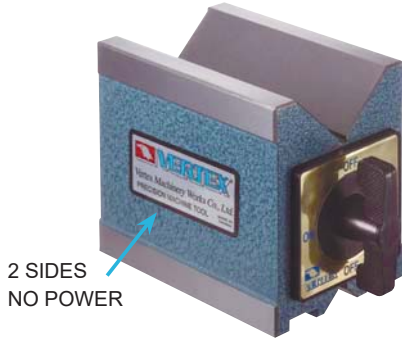

ORDER NO.	Magnetic Power(pull)	V	v	Dimension					Wt. kgs	CODE NO.
				H	W	L	L1	L2		
VCP-25	70kgf	ø7~ø60	ø7~ø25	95.3 3.75"	70 2.76"	101.6 4"	45 1.97"	18 0.75"	3.9	2015-501



Magnetic V Block

1 PCS

- For round / square workpiece
- For checking on surface plate during the production.
- For measuring
- V ANGLE 90°
- ※ Not for LAB.

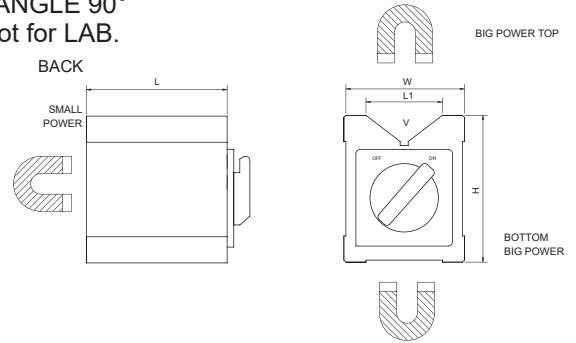
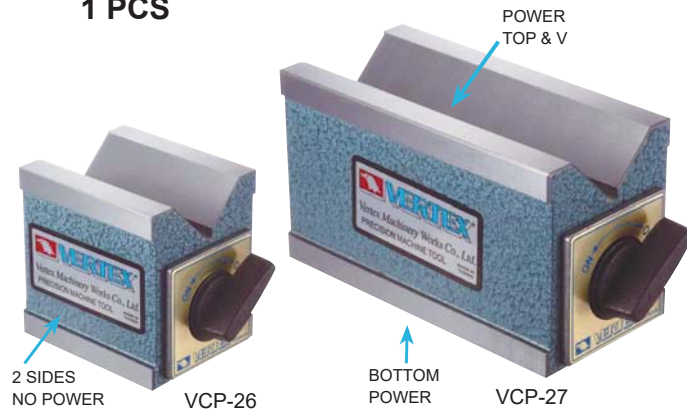

ORDER NO.	Magnetic Power(pull)	V	Dimension				Wt. kgs	CODE NO.
			H	W	L	L1		
VCP-26	50kgf	ø8~ø50	73 2.87"	60 2.13"	70 2.76"	37 1.5"	1.8	2015-510
VCP-27	70kgf	ø8~ø50	73 2.87"	60 2.36"	125 4.29"	38 1.5"	3.3	2015-511



Magnetic V Block

PAIR

Magnetic V-Block

- Two pieces finished to the same dimension and accuracy are used together as a set.
- For round / square workpiece
- For checking on surface plate during the production.
- V ANGLE 90°
- ※ Not for LAB.

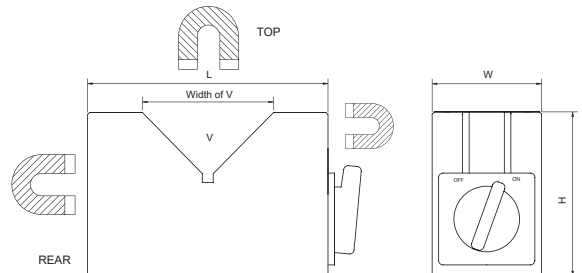
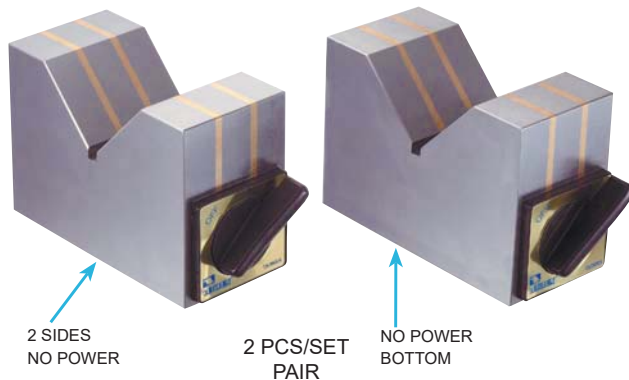

ORDER NO.	Magnetic Power(pull)	V	Dimension			Width of V	Wt. kgs	CODE NO.
			H	W	L			
VCP-29	17kgf	ø8~ø80	74 2.91"	48 1.77"	110 4.33"	60 2.36"	4.9	2015-521
VCP-30	23kgf	ø8~ø120	100 3.94"	50 1.97"	150 5.91"	90 3.54"	8.9	2015-522



Magnetic Square Block

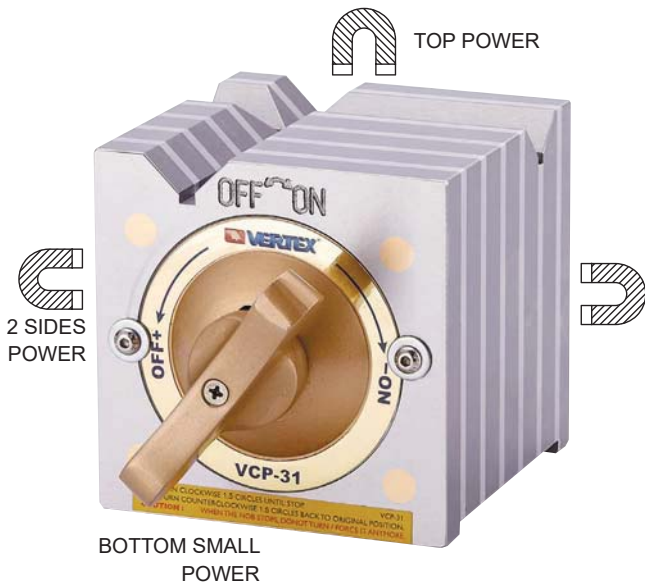

FOR MEASURING

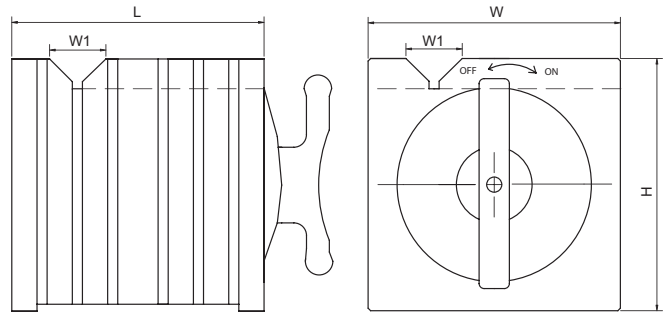

MAGNETIC BLOCK

- The V-Blocks and Parallels transfer the magnetism from permanent magnetic chucks.
- The steel used in all V-Blocks and Parallels is selected for the highest magnetic transfer and is cast integrally with aluminum.
- For measuring
- V ANGLE 90°
- ※ Not for LAB

ORDER NO.	Mag. Power of V groove	Mag. Power of base	V	H	W	L	W1	Wt. kgs	CODE NO.
VCP-31	25kgf	50kgf	ø7~ø32	100 3.94"	100 3.94"	100 3.94"	23 1.02"	6.5	2015-530
VCP-32	50kgf	140kgf	ø8~ø42	150 5.91"	150 5.91"	150 5.91"	29 1.26"	23	2015-531



Magnetic Square Holder

NEW

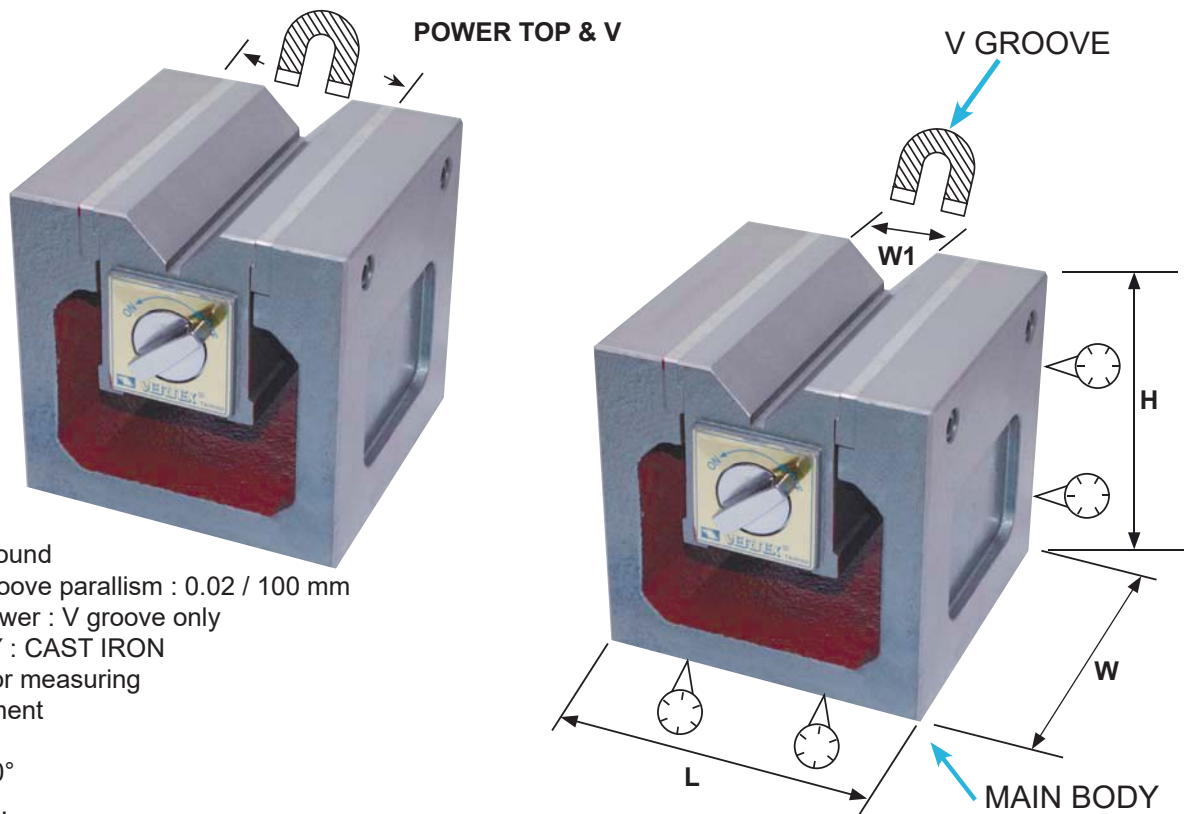

- Precision ground
- Base & V groove parallism : 0.02 / 100 mm
- Magnetic power : V groove only
- MAIN BODY : CAST IRON
- Light duty, for measuring
- Easy movement
- Multi - type
- V ANGLE 90°
- ※ Not for LAB.

ORDER NO.	Mag. Power of V groove	V	H	W	L	W1	Wt. kgs	CODE NO.
VCP-40	70kgf	ø8~ø50	125	125	125	37	8.54	2015-540