



Precision Universal Angle Vise



PAT.

NEW



VUA-3



VUA-4

- Precision graduation for accurate reading.
- Its swivelling and tilting features make this unit well suited for straight or inclined surface, angular drilling machining on various machine tools as precision grinding machine, boring and milling machine, electrical discharge machine etc.
- Tolerance $\pm 0.01\text{mm}/100\text{mm}$.
- Vise bottom to base parallelism $\pm 0.02\text{ mm}$
- Squareness ± 0.02
- 360° Horizontal swivel
- 45° Vertical tilting
- Precision ground
- Material: VISE SK-2
- Hardness: HRC $52^{\circ}\pm 2^{\circ}$
- Load capacity : 25kgs

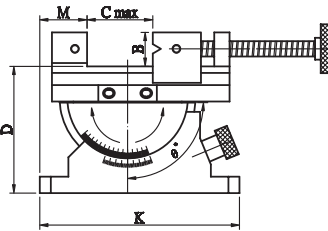
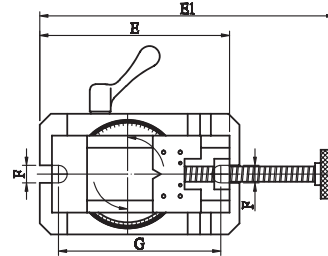

Unit:mm

ORDER NO.	A	B	C MAX	D	E	E1	F	G	H	I	J	K	M	N	θ	G.W(KGS)	CODE.NO.
VUA-3	70	31	80	115	173	291	16	156	63	146	110	182	43	16	-20°~50°	12	2003-050
VUA-4	88	35	110	132	193	346	16	156	83	167	110	182	29	16	-20°~50°	15	2003-051



Precision Universal Angle Plate



- Precision grounded.
- Rigid design.
- The table can swivel 360°, and tilts 45°
- It can put tool maker vise VMV-type VDV-type or 3 jaw chuck for clamping
- The graduation for accurate reading
- Vise bottom to base parallelism $\pm 0.02\text{ mm}$
- Squareness ± 0.02
- Material: SK-2
- Hardness: HRC $52^{\circ}\pm 2^{\circ}$
- Load capacity : 25kgs

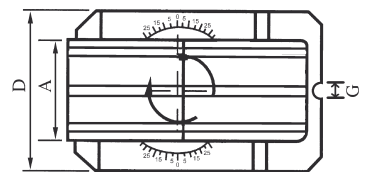
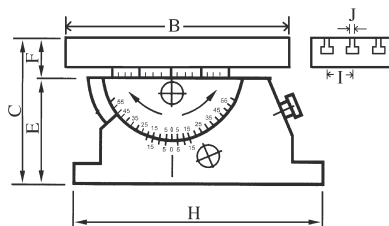

ORDER NO.	A	B	C	D	E	F	G	H	I	J	G.W (kgs)	CODE NO.
VUA-408	100	200	133	110	83	50	16	182	30	12	15	2003-055
VUA-510	126	250	133	110	83	50	16	182	40	12	18.1	2003-056