



# Precision Universal Angle Chuck



With VSC-4 Chuck

NEW

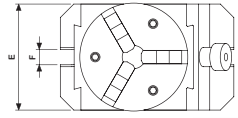
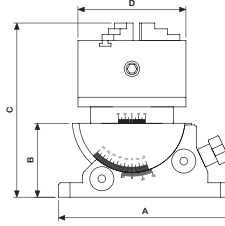

- With VSC-4 3-Jaw chuck.
- O.D. clamping  $\varnothing 3-90$  mm,
- I.D. clamping  $\varnothing 32-84$  mm.
- Tolerance  $\pm 0.01$ mm/100mm.
- 2 axis with angle scale
- For angle setting
- Chuck indexing / Rotating setting by scale.
- Tilting Features same as VUA series, Page B13.
- Load Capacity :25Kgs



ORDER NO.	A	B	C	D	E	F	G.W (kgs)	CODE NO.
VUA-100J	180	77	181	112	110	16	14	2003-060



# Precision Universal Angle Collet Chuck

Capacity  $\varnothing 3-\varnothing 30$

NEW

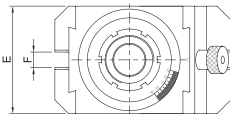
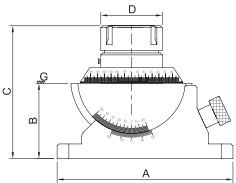

- Tolerance  $\pm 0.01$ mm/100mm.
- 360° horizontal swivel, 45° vertical tilting.
- Suit for multi - angle cutting.
- Simple way for mass production.
- Hardness : HRC52 $\pm 2$ °
- Load Capacity :25Kg



Standard Accessories: With 15pcs ER-40 Collet (4, 5, 6, 8, 10, 12, 13, 15, 16, 18, 20, 21, 22, 25, 26)

ORDER NO.	A	B	C	D	E	F	G.W (kgs)	CODE NO.
VUA-ER40	180	77	136	63	110	16	12	2003-065



# Free Angle Rotary Chuck

NEW

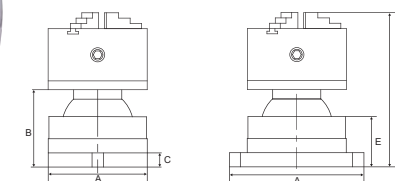
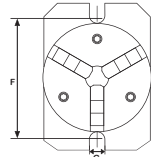

- With VSC-4, VSC-5, 3-JAW Chuck.
- O.D. Clamping  $\varnothing 3-90$  mm (VSC-4)
- O.D. Clamping  $\varnothing 3-110$  mm (VSC-5)
- I.D. Clamping  $\varnothing 32-84$  mm (VSC-4)
- I.D. Clamping  $\varnothing 35-100$  mm (VSC-5)

### Features:

- Quick setting
- Operating is very quick and easy, can increase so much working efficiency than you can image.
- 360° Rotation, Tilting 30°
- For non-normal angle setting.
- Its swivelling and tilting features with chuck clamping make this unit for round & square, angular drilling machining on various machine tools or for bench work table.



ORDER NO.	A	B	C	D	E	F	G	H	Weight (kgs)	CODE NO.
VAV-4J	140	120	20	190	72	158	17	203	16	1002-217
VAV-5J	140	120	20	190	72	158	17	203	17	1002-218